

# iLED<sup>®</sup> 7 Surgical Light

The World in a New Light



Enhancing outcomes for  
patients and their caregivers:

**Hill-Rom**

# Intelligent Lighting

Innovative technology is a key factor to consider when improving the OR environment. With its new generation of LED OR lights, Trumpf Medical is once again setting new standards: the iLED® 7 Surgical Light — the LED light that reacts.

At Trumpf Medical, clinical needs, patient safety and ease of use are always primary considerations in the development of new products. Accordingly, the revolutionary technology of the iLED® 7 Surgical Light enables OR personnel to work under optimum lighting conditions at all times.

The automated lighting management system uses the latest 3D sensor technology to continuously analyze the surgical site. By interpreting the conditions, the light automatically adapts and eliminates the need for manual adjustment. In addition, an innovative shadow management system ensures unwanted shadows, such as those cast by the surgeon's head, are compensated for automatically. The surgeons are able to fully concentrate on the patient and the task at hand.



## Why the iLED® 7 Surgical Light is the right choice:

- The lighting management system **automatically** maintains the brightness, color temperature and a consistent pattern size.
- The **unique** shadow management system ensures superior illumination at all times.
- Once the desired settings are established, lighting conditions remain **consistent** at working distances between 31" and 51".
- **Streamlined** design for enhanced air flow.
- The **flexible** interface allows the light head to be fitted with standard, disposable, camera and sterile light control handles — upgradeable at any time.
- **Compatible** with all standard video integration systems.





3D sensor technology provides consistent lighting of the surgical site.

## SmartShadow

The iLED® 7 Surgical Light's 3D sensor system provides consistent lighting conditions and eliminates unwanted shadows, even when the surgeon is working directly beneath the light head. The system identifies obstacles in the field of illumination and activates or deactivates individual LED modules accordingly. As a result, the surgical field is properly illuminated without the need for manual adjustment allowing the surgeon to focus on the patient and the task at hand.



Consistent illumination at typical working distances.

## SmartIllumination

When the light head is repositioned, the 3D sensor automatically adjusts to ensure a consistent illumination level. This eliminates any manual readjustments to the lighting conditions — saving time and allowing the surgeon to focus on the surgical site.



All iLED® 7 Surgical Light's are camera ready — enabling you to upgrade at any time.

## SmartFlexibility

The flexible interface allows the light head to be fitted with standard, disposable, camera and sterile light control handles. Therefore, all light heads are camera ready — enabling you to upgrade your light head at any time.

# The Smart Features of the iLED<sup>®</sup> 7 Surgical Light



To find out more information, visit:  
[www.trumpfmedical.com/us](http://www.trumpfmedical.com/us)



Optional pattern sizes: 10", 8" or 6".

## SmartPattern

Once the surgeon has selected the pattern size (6", 8" or 10"), the light head automatically maintains that size throughout the procedure, at any typical working distance.



Intuitive and reliable wall control.

## SmartControl

The iLED® 7 Surgical Light uses an intuitive, touchscreen interface to adjust features of the light before or during the surgical case. In addition, a sterile handle option is available for surgeon control.

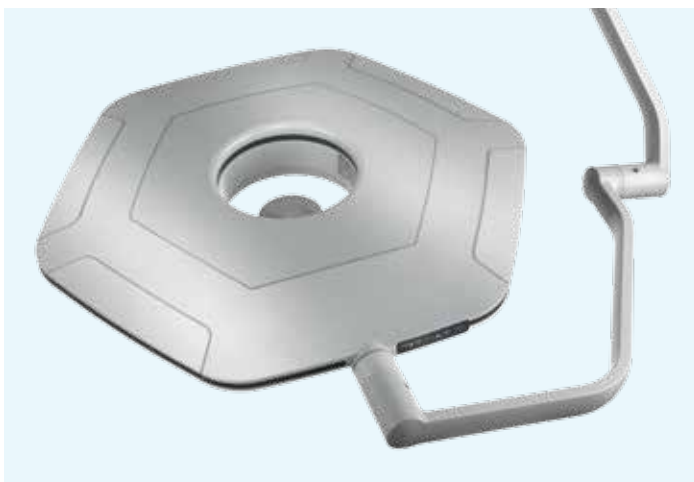

Streamlined design for enhanced air flow.

## SmartDesign

The slim design of the iLED® 7 Surgical Light, developed from specific requirements of OR personnel, is ideal for conventional or laminar air flow systems. Key design elements include the opening in the center of the light, the rounded edges and smooth surfaces, making it easy to clean. Additionally, the compact design and lightweight materials support and simplify positioning.

## Compatible with the Latest Generation of Cameras

The iLED® 7 Surgical Light can be directly connected to the innovative TruVidia® Wireless Camera System via the handle, providing clear images in full HD. Individual images for documentation purposes are possible using the snapshot function. Benefits of wireless technology: ability to install and/or upgrade this system with minimal additional cost or the need for complex video cabling.



TruVidia® Wireless Camera System provides excellent image quality and encrypted transfer provides maximum data security.

### Technical Specifications

Illumination level $E_c$ in 1 m (lx)	160,000
Focusable light field size (d10) in 1 m	6.3-9.8" (16-25 cm)
Color temperature (K)	3,500   4,000 4,500   5,000
Color rendering index (Ra)	max. 97
Dimming range (%)	Endo <5 30-100%
Depth of illumination (L1+L2) at 20% $E_c$ / 2nd Edition	76" with ALC Plus (193 cm)
Shadowing with 1 shadower without tube	92%
Shadowing with 1 shadower with tube	91%
Shadowing with 2 shadowers without tube	68%



For more information, visit  
[www.trumpfmedical.com/us](http://www.trumpfmedical.com/us)

Hill-Rom is a leading global medical technology company with approximately 10,000 employees worldwide. We partner with health care providers in more than 100 countries by focusing on patient care solutions that improve clinical and economic outcomes in five core areas: **Advancing Mobility, Wound Care and Prevention, Clinical Workflow, Surgical Safety and Efficiency, and Respiratory Health.** Around the world, Hill-Rom's people, products, and programs work towards one mission: **Every day, around the world, we enhance outcomes for patients and their caregivers.**

Trumpf Medical, a division of Hill-Rom Holdings, Inc., develops and produces modern medical equipment for the OR, ICU, ED and associated clinical areas, providing hospital staff with the best possible support in delivering efficient and safe care to their patients. Its product range includes flexible OR tables, modular booms, as well as innovative OR lighting technologies and camera systems.

This document is destined solely for use by healthcare professionals. Medical devices shown in this brochure are intended for use with patients in departments of healthcare establishments.

These products are regulated health care products which, where required by applicable regulations, bear a CE mark. Hill-Rom recommends you carefully read the detailed instructions for safe and proper use included in the documentation accompanying the medical devices. The personnel of healthcare establishments are responsible for the proper use and maintenance of these medical devices.

TruVidia® is a registered trademark of TRUMPF GmbH & Co. KG.

Hill-Rom reserves the right to make changes without notice in design, specifications and models. The only warranty Hill-Rom makes is the express written warranty extended on the sale or rental of its products.

©2016 Hill-Rom Services, Inc. ALL RIGHTS RESERVED.  
196854 rev 1 29-FEB-2016 ENG – US

For further information about this product or a service, please contact your local Trumpf Medical representative or visit our webpage:

[www.trumpfmedical.com/us](http://www.trumpfmedical.com/us)